

SEDAN

5-3

FIAT - 600 & 600D

MODEL IDENTIFICATION

SEE PAGE Aa, for SPARE PARTS ORDERING INFORMATION.
CHASSIS & ENGINE NUMBERS MUST BE GIVEN WITH ALL PARTS ORDERS.

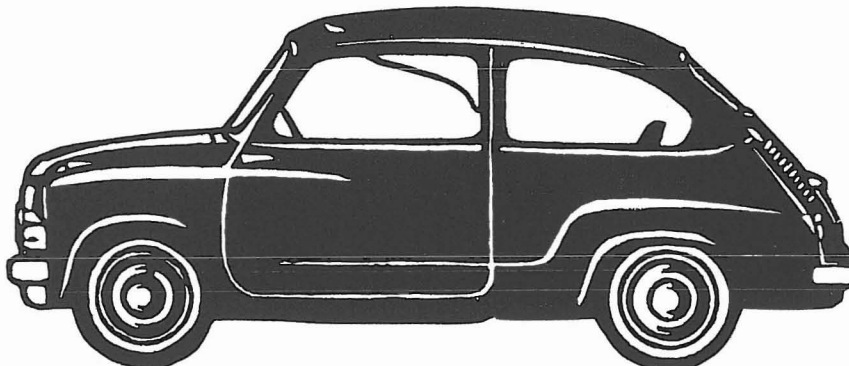

600 SEDAN - 100.140



600D SEDAN - 100D.100

SUGGESTED PRICE PROCEDURE

Prices listed here are Factory suggested list prices. They are not intended to be construed as determinative of the price you or any dealer will charge on resale. Therefore, we suggest that the purchaser (of parts listed here) check with your local dealer and establish the necessary procedure to cover your reasonable profit.

WARNING :

WHOLESALE DISCOUNT on FIAT Parts is L O W.
The prices listed here may be about Repair Shop
Net, CHECK with your Dealer.

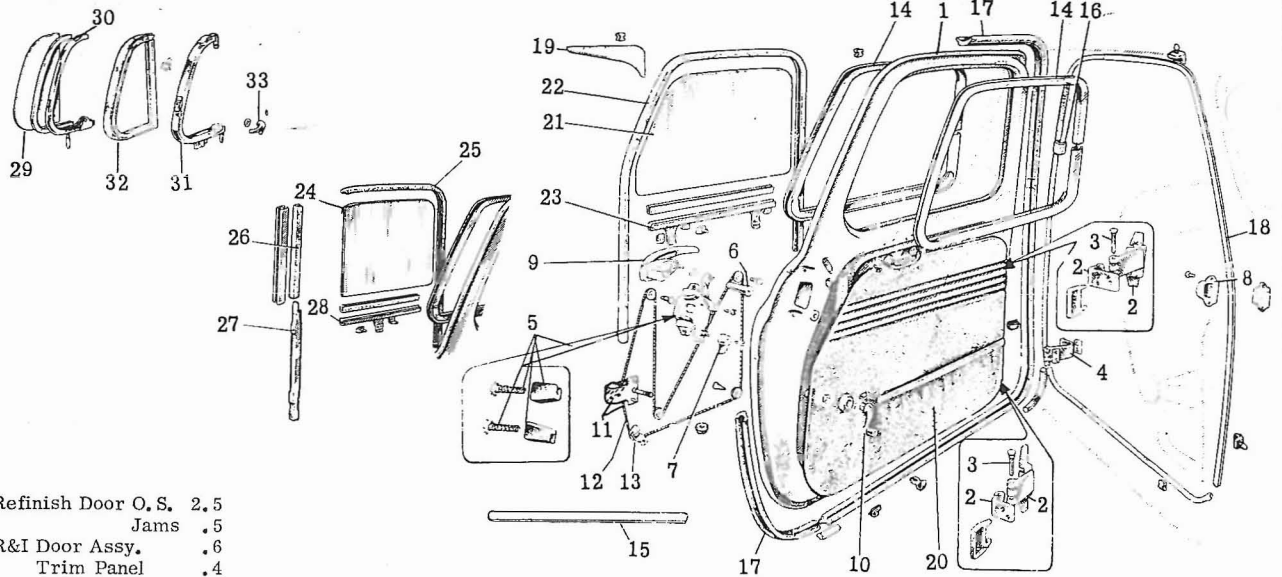

Refinish Door O. S. 2.5
 Jams .5
 R&I Door Assy. .6
 Trim Panel .4

DOOR

* ARE FACTORY SUGGESTED ALLOWANCES
 OTHER GLENN MITCHELL ESTIMATED.

	TIME	PRICE		TIME	PRICE
1 DOOR SHELL 600	3.0	50.68	19 Plate, anti-draught		3.26
600D	3.0	43.44	20 Panel, door trim i. s.	.5	10.98
2 Hinge Half, Upper or Lower # R&R Upper & Lower Complete	1.2	1.09	WINDOW PARTS for DOOR w/o VENT WINDOW 600		
3 Pin, Hinge	1.7	.23	21 Glass, Window	1.0	11.84
4 Strap, door check	* .2	.37	22 Channel, Glass Run	1.2	2.93
5 LOCK, w/safety device	* .6	3.08	23 Channel lower	1.0	1.53
6 Knob, lock i. s. control		.37	WINDOW PARTS for DOOR w/VENT WINDOW 600D		
7 Lever, lock i. s. control		.13	24 GLASS, DOOR WINDOW 600	1.0	7.49
8 Plate, striker		1.09	600D	1.0	8.35
9 HANDLE, o. s., w/lock cylinder w/o lock cylinder	* .6	3.99	25 Channel, Glass Run Rear		
10 i. s. regulator Vent window - See Vent	* .2	2.18	26 Division Bar		
11 REGULATOR, Door window	* .1	1.27	27 Lower Retainer Div.		1.45
12 Rope, regulator	* .9	7.24	28 Glass Lower	1.0	1.74
13 Bracket w/sheave, lower		1.28	29 GLASS, Vent Window	.5	3.30
14 MOULDING, Window i. s. or o. s.		.73	30 Frame, Vent Glass	1.2	5.43
15 Door o. s.		2.54	31 Vent Window		3.62
16 Joint Cover, Window mold		.91	32 Weatherstrip, Vent Window	1.0	2.18
17 Weatherstrip, door	* 1.3	.08	33 Handle, Vent Window	.2	1.02
18 door opening	.7	1.45			
		2.18			

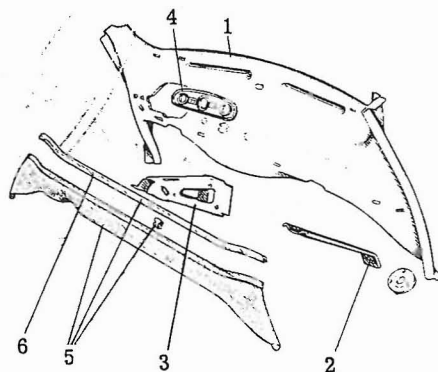

INSTRUMENT PANEL

1 INSTRUMENT PANEL	6.5 exc. w/Pillar R&R	4.0	10.86
2 Plate, mounting			
3 mounting w/support			
4 central garnish			
5 Padding, instrument panel	2.0		7.24
6 Moulding, trim	.8		2.57



VISOR

7 VISOR	.1	1.81
8 Hinge, visor		.34
9 Bracket, rr. view mirror		.41

MISCELLANEOUS

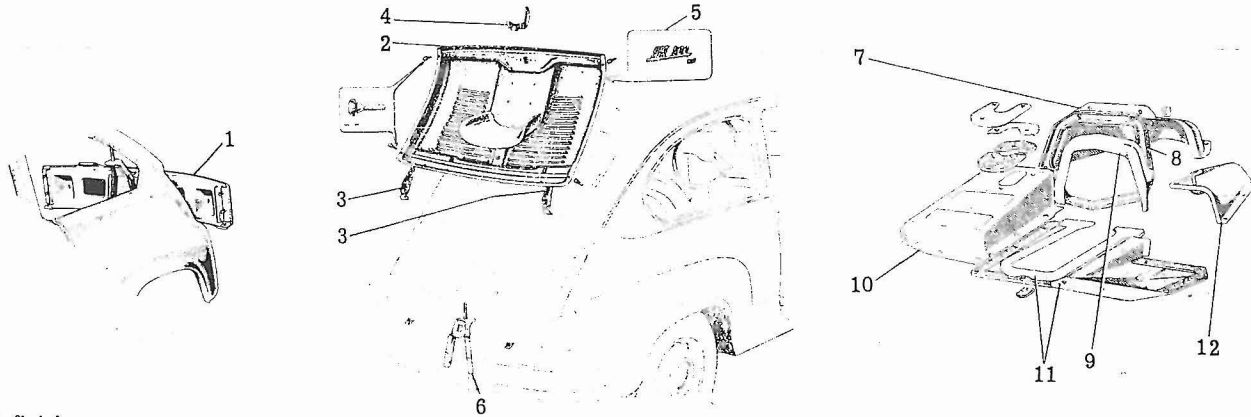

Refinish:
 Rr. Lid 2.0
 Rr. Body Panel 1.0

BODY- REAR

	TIME	PRICE		TIME	PRICE
1 REAR BODY PANEL	4.0	9.05	7 Shield, gear box & starter		5.46
2 LID, rear compartment	.9	31.50	8 Gasket, shield		1.09
3 Hinge, rear lid	.3	1.09	9 Rubber, gear box		1.46
4 Handle, w/latch assy.	.3	1.45	10 APRON, lt. rr. (engine)		2.19
5 Name Plate, Fiat 600	.1	.73	11 rt. central (engine)		8.33
6 Support, w/lid striker, rr. engine	1.3	1.63	12 Warm Air Conveyer		1.46

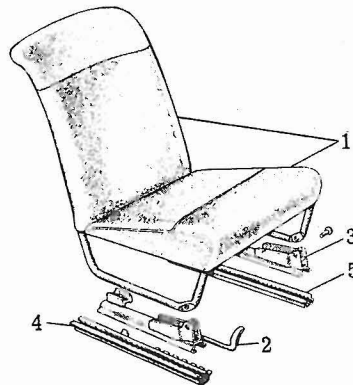

SEATS

	TIME	PRICE		TIME	PRICE
1 FR. SEAT ASSY., imitation leather	.4	65.45	4 Guide, rt. stationary		.73
2 Guide, rt. sliding	.7	2.00	5 lt. stationary		.73
3 lt. sliding	.7	.87			

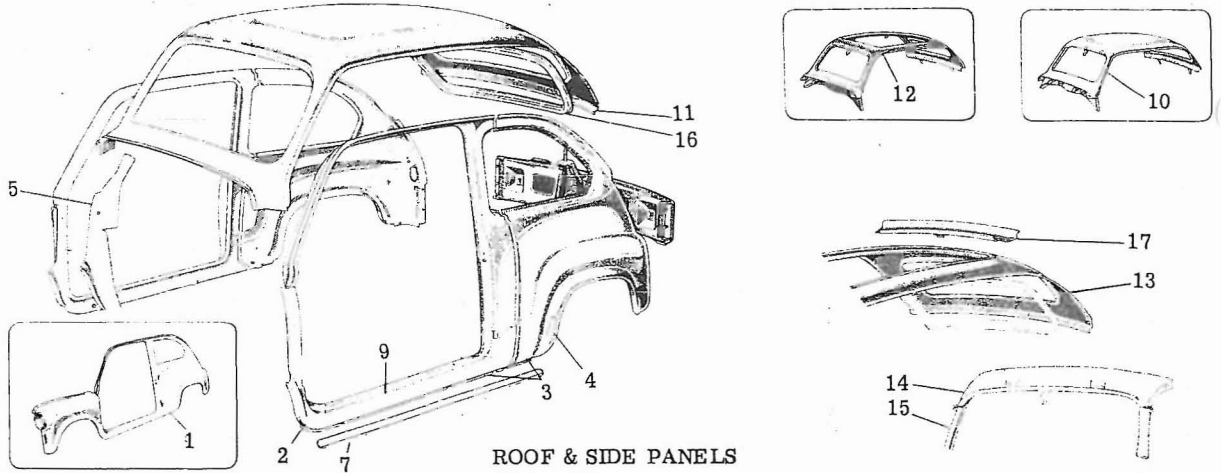

ROOF & SIDE PANELS

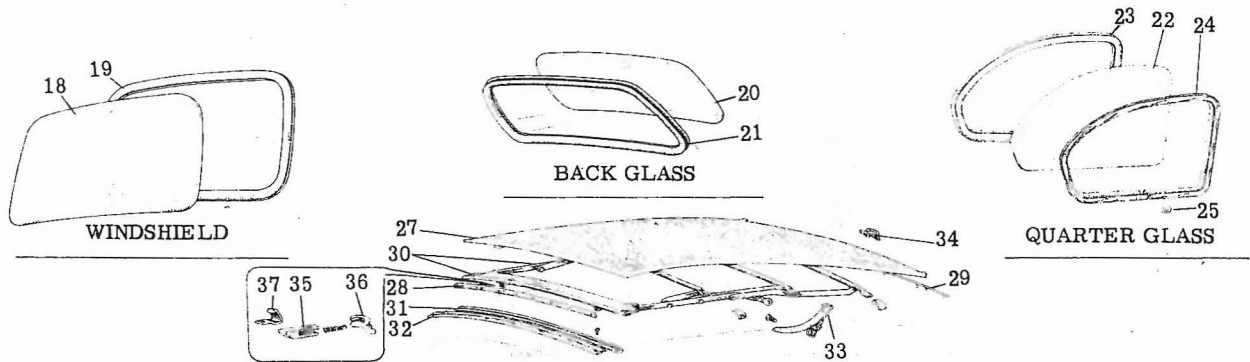

SUNROOF TOP

Refinish:
Cowl Top Panel 1.0
Body Side
Less Fr. Fen. & Dr. 3.5
Pillar 1.0
Rocker Panel 1.0
Roof 4.0

* ARE FACTORY SUGGESTED ALLOWANCE
OTHER GLENN MITCHELL ESTIMATED

BODY-SIDE & ROOF

	TIME	PRICE		TIME	PRICE
1 PANEL ASSY, w/fr. fen. & qtr. -side, Note 1	24.0	72.40	SUNROOF TOP		
2 door aperture frame -side, Note 2		14.48	27 Cover, roof, imitation leather	1.0	27.15
3 door aperture w/qtr. panel Note 1	18.0	47.06	28 Moulding, front roof	.3	1.10
4 rr. qtr. w/o inner Note 3		28.96	29 Strip, hold down at rear		1.38
For i/s panels see Frame & Bumper Section			30 FRAME, TOP	1.5	20.01
5 PILLAR, front	3.5	3.65	31 Weatherstrip, front	.3	.74
Reinforcement, lwr. fr. pillar		2.00	32 Moulding, hold down at front	.3	1.02
7 Mold, rocker panel	.3	1.45	33 Strap, retaining	.2	1.20
9 ROCKER PANEL, use item No. 2, cut & splice under door	3.0	12.67	34 Bracket, outer for strap		.30
10 ROOF PANEL, hard top compl. w/reinf.	20.0	72.40	35 Striker, top	.1	.73
11 w/o reinf.	22.0	59.73	36 Handle, top	.2	.38
12 sunroof compl. w/reinf.	21.0	72.40	37 Seat, striker	.1	.05
13 w/o reinf.	22.5	54.30			
14 Crossmember, upper w/s frame	#	5.43	NOTE 1: R&R includes upholstery, necessary glass & lamps. Does not include door.		
# R&R w/glass & trim removed	1.5		NOTE 2: Not practical to splice unit in qtr. panel section. Cut & use only parts needed.		
15 Pillar, w/s inner		.48	fr. hinge pillar section w/item no. 5 (w/fen. rem.)	4.5	
16 Frame, back window	#1	2.18	door pillar section	5.5	
#1 R&R w/glass & trim removed	1.8		rocker panel section		
17 Crossmember, rear, sunroof		1.10	under door	3.5	
18 W/S GLASS, Car Mfg.	* 1.4	57.26	NOTE 3: Not practical to splice in qtr. panel section. Use item 3. Cut at rear of door opening & bottom of qtr. window opening	13.0	
Glass Co.	* 1.4	48.05			
19 Weatherstrip, W/S	* 1.1	3.99			
20 BACK GLASS, Car Mfg.	* 1.1	15.91			
Glass Co.					
21 Weatherstrip, Back glass		2.90			
22 QUARTER GLASS, Car Mfg.	1.0	9.32			
Glass Co.	1.0	11.28			
23 Weatherstrip, Qtr. glass		2.90			
24 Moulding, Qtr. window, outer		1.45			
25 Cover, mold, joint		.06			
Panel, Qtr. upholstery		7.27			

ELECTRICAL

TYPICAL

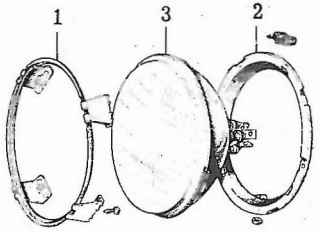

HEADLAMP

TIME PRICE

HEADLAMP ASSY. w/o Door	* .4	
Door	* .1	8.33
1 Retainer Rim		1.45
2 Seating Ring	.4	7.24
3 Sealed Beam	* .3	2.60
Gasket to Fender		

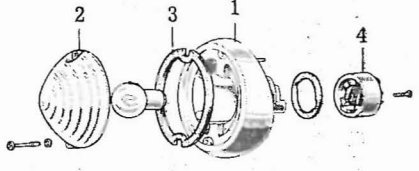

PARKING & SIGNAL LAMP

PARKING LAMP w/Signal Lamp		4.66
1 Body - Not Serviced.		
2 Lens		1.17
3 Gasket, Lens		.24
Bulb		
4 Block, Terminal		1.50

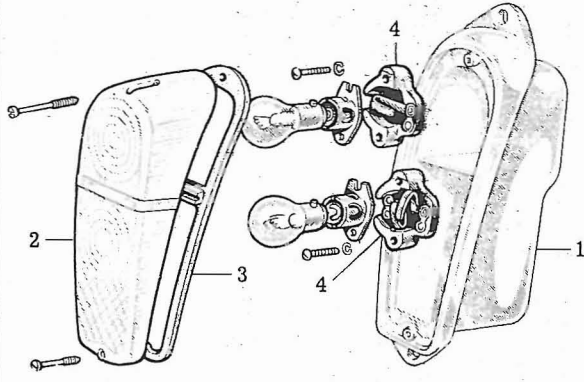

TAIL LAMP - 600

TAIL LAMP - 600	* .3	8.15
1 Body - Not Serviced.		
Bulb, Signal Lamp or Stop Lamp	* .2	
2 Lens		1.56
3 Gasket, Lens		.51
4 Block, Terminal		.86

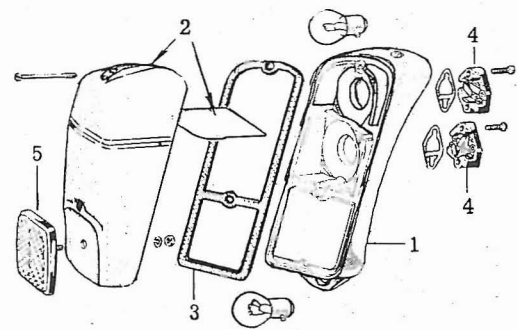

TAIL LAMP - 600D

TAIL LAMP - 600D	.3	11.64
1 Body - Not Serviced.		
Bulb, Signal Lamp		.73
Stop Lamp		.95
2 Lens		4.85
3 Gasket, Lens		.63
4 Block, Terminal		.86
5 Reflector, Lens		2.33

(W/O ILLUSTRATION)

LICENSE LAMP

LICENSE LAMP	* .3	5.50
Body - Not Serviced.		
Bulb		.38
Lens		
Holder, Bulb		

(W/O ILLUSTRATIONS)

WINDSHIELD WIPERS

SWITCHES	TIME	PRICE
Signal Lamp		8.74
Horn Control		1.47
HORN		
HORN	* .2	17.46
BATTERY COVER		
COVER, Battery		2.93

MOTOR	TIME	PRICE
WIPER ASSY. 600	* .8	34.56
WIPER ASSY. 600D	* 1.5	71.78
Arm	* 1.5	69.84
Blade 600		3.03
Blade 600D		3.19
Spindle thru Cowl		2.84
Lt. (use w/Square Type Motor)	1.5	.86
Rt. (use w/Square Type Motor)		.78
Spindle Assy. thru Cowl (use w/Round Type Mtr.)		6.58

* ARE FACTORY SUGGESTED ALLOWANCES
OTHER GLENN MITCHELL ESTIMATED.

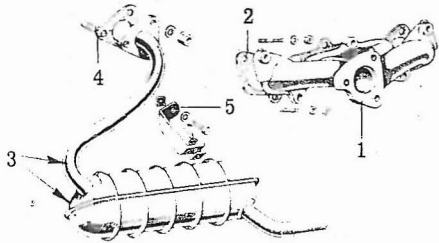

EXHAUST & MANIFOLDS

		TIME	P	
1	MANIFOLD	600	.6	9.05
		600D	.6	7.97
2	Gasket			.46
3	MUFFLER w/WELDED BRKT.	600	* .5	13.40
		600D	* .5	13.40
4	Gasket, Muffler			.13
5	Bracket, Muffler (Early Model)			

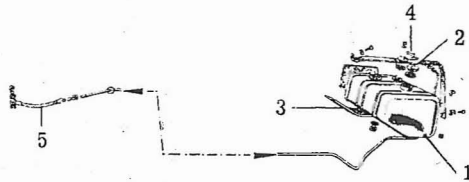

FUEL

1	TANK. Fuel		* .6	21.00
2	Cap, Filler			2.90
3	Strap, Tank Mtg.			.73
4	Suction Pipe w/Gauge Unit			7.24
5	Pipe to Pump			2.72
	Hose to Pump			1.27
	Gauge in Tank			7.25

R&I Engine Assy. * 3.4

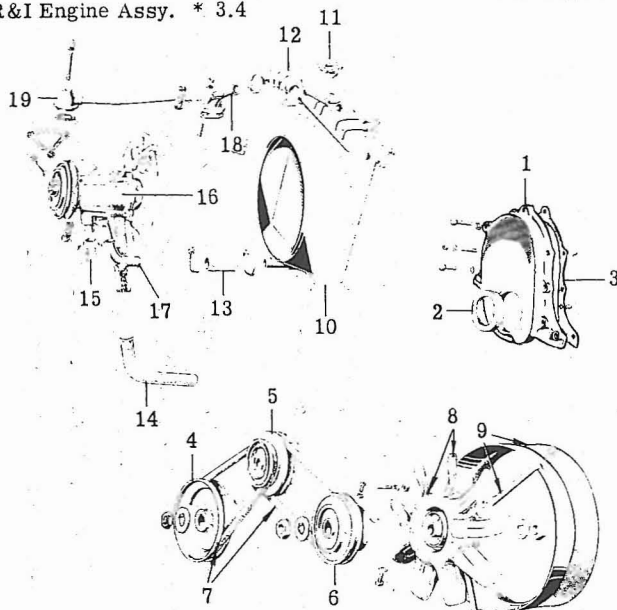

COOLING & ENGINE

1	COVER, Timing Gear 600 (w/Rad.Rem.)		* 1.2	7.24
		600D	* 1.2	6.16
2	Gasket, Cover Seal			.51
3	Cover to Block			.17
	OIL PAN (w/o Illustration)	#	* 5.7	9.05
	# Time Includes R&I Engine.			
4	PULLEY, Crankshaft 600		* .9	2.36
		600D (w/Filter Assy)	* 1.1	4.71
5	Idler			
6	Fan 600 Complete Assy.			3.62
		600D Mtg. Flange		3.62
7	Belt, Fan or Generator		* .3	1.75
8	FAN		* .9	5.43
9	Cowling, Fan			5.80
10	RADIATOR		* 1.0	48.28
11	Cap, Radiator			1.45
12	HOSE, Upper	600	#	.3
		600D	#	.3
13	Lower	600	#	.4
14		600D	#	.4
15		at Pump 600D	#	.4
	# R&R One w/Radiator Removed			.1
16	WATER PUMP		* .8	28.96
17	Elbow, Water Inlet			
18	Upper			2.18
19	Pipe, Water			
	TEMPERATURE GAUGE, Block Unit 600		.2	3.44
		600D	.2	1.81
	ENGINE MTS. - SEE Transmission			

FRONT BODY

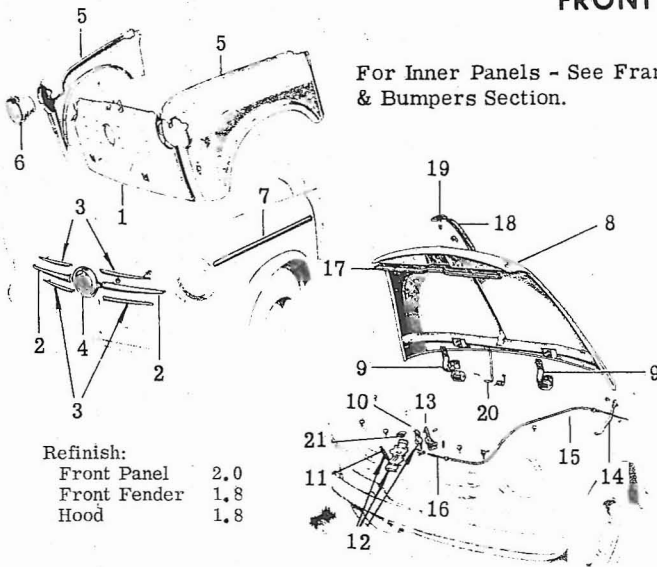

For Inner Panels - See Frame
& Bumpers Section.

Refinish:
Front Panel 2.0
Front Fender 1.8
Hood 1.8

1	PANEL, Front Outer Shell	#		14.48
	# R&R Shell, w/o R&R Fenders			7.5
		w/One Fender Removed		5.0
		w/Both Fenders Removed		3.0
2	Mold, Lt. or Rt. Center, Shell		.2	2.43
3	Upper or Lower, Lt. or Rt.		.2	1.09
4	Ornament, Fiat		.2	2.18
5	FENDER, Front		5.0	12.67
6	Shield, Headlamp			1.63
7	Mold, Front Fender Side		.2	.56
8	LID, Front		1.0	31.50
9	Hinge		.4	1.09
	LOCKING MECHANISM (R&R Assy., O/H)		.4	1.65
10	Hook			.48
11	Spring		* .2	.10
12	Supporting Plate			1.63
13	Safety Hook			.55
	CATCH RELEASE CONT. (R&R Assy., O/H)		* .5	
14	Lever			.51
15	Bowden			.91
16	Wire			.08
17	WEATHERSTRIP, Front		.3	.37
18	Ornament		.2	.55
19	Name Plate		.2	
20	Prop		* .1	
21	Spring, Raising			.17

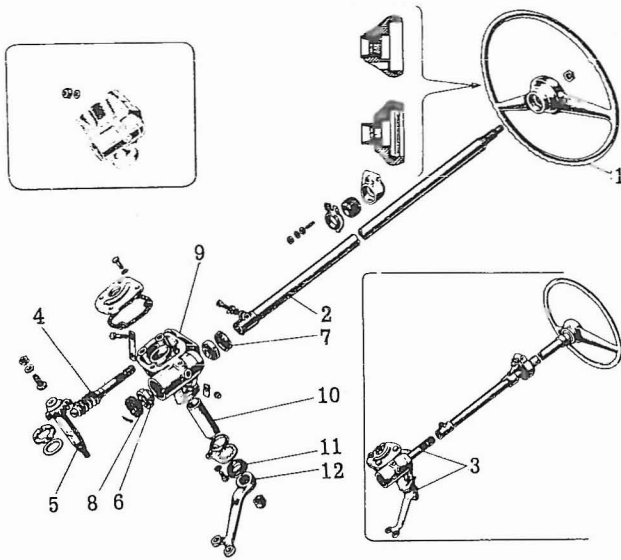

O/H Steering Gear Inc.R&R
R&R Gear Assy.

*3.3
*1.4

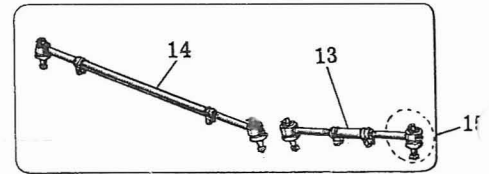

Linkage by two track rods connected to Pitman Arm

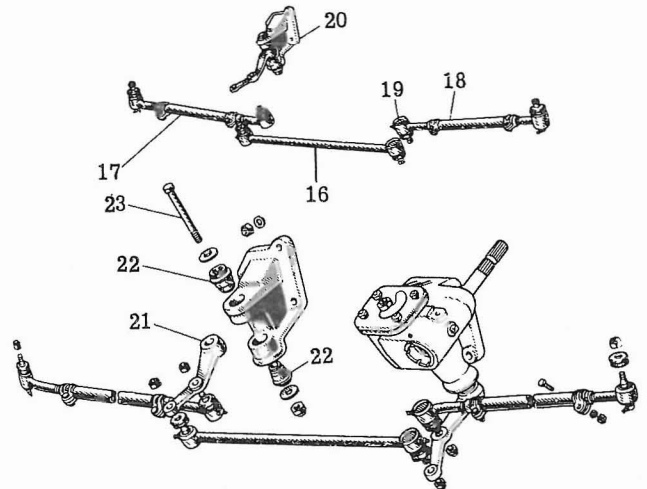

#1 Linkage by two equal length rods and a central rod.

O/H Steering Linkage *2.0
Inc.Adjust Toe-In
Check & Adjust Toe-In * .6
R&R does not include Adjust Toe-In

* ARE FACTORY SUGGESTED ALLOWANCES
OTHER GLENN MITCHELL ESTIMATED.

STEERING

		TIME	PRICE
1	WHEEL, Steering	* .4	10.14
2	Shaft, Strg. Wheel		6.16
3	GEAR, Steering	Early Type * 1.4	36.20
		Late Type * 1.4	36.20
4	WORM SCREW,	600 O/H * 3.3	7.61
		600D	4.71
5	SECTOR SHAFT,	To Ch.352029	9.42
		From Ch.352030 & D	
6	Bearing, Worm Screw		3.80
7	Seal, Upper		.37
8	Adjuster		.73
9	HOUSING		10.86
10	Bushing, Sector		2.83
11	Seal, Lower		.19
12	ARM, PITMAN	600 * 1.1	5.43
		600D * 1.1	4.71

		TIME	PRICE
LINKAGE - BY 2 TRACK RODS CONNECTED TO PITMAN ARM.			
13	ROD ASSY., Left Track	.5	8.78
14	Right Track	.5	8.78
15	END, Tie Rod	.4	4.35
LINKAGE - BY 2 EQUAL LENGTH RODS & A CENTRAL ROD.			
16	ROD, Rt. Link Assy. w/Ends	.5	9.05
17	600 Rt. Track Assy. w/Ends	.5	9.78
18	Lt. Track Assy. w/Ends	.5	8.78
	600D Rt. or Lt. Track Assy. w/Ends	.5	8.33
19	END ASSY.	.4	3.62
20	SUPPORT ASSY., Idler w/Lever exc. 600D	* .5	10.86
		.5	14.50
21	LEVER, Relay	* .8	3.62
22	Bushing, Relay 600		
	600D		4.00
23	Pin, Relay		

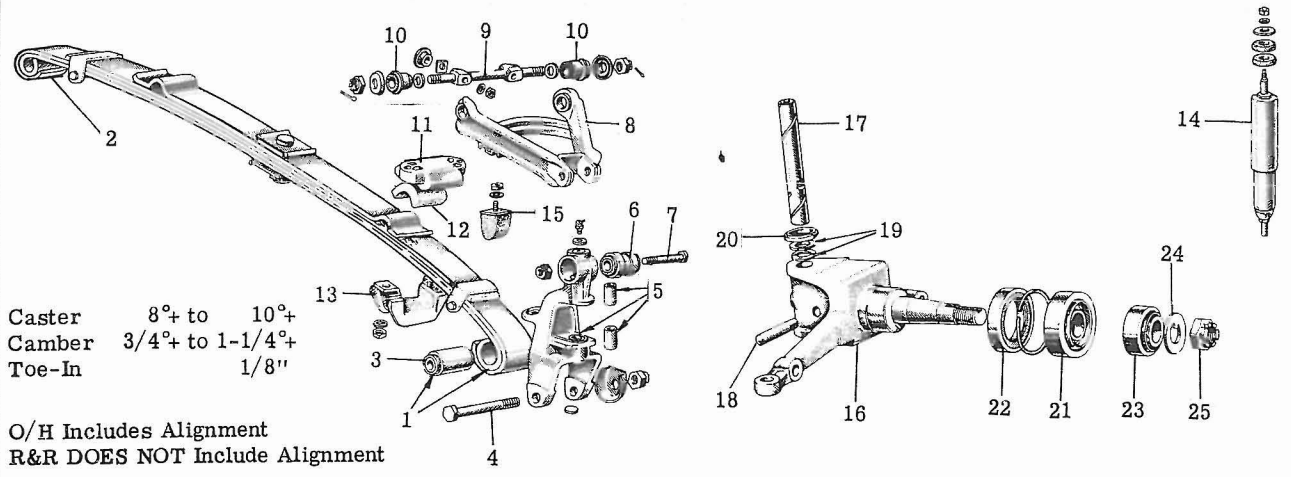

Caster 8° to 10°+
 Camber 3/4° to 1-1/4°+
 Toe-In 1/8"

O/H Includes Alignment
 R&R DOES NOT Include Alignment

- R&R Suspension Assembly * 2.8
- O/H One Side * 3.5
- Both Sides * 5.6
- CORRECT Caster, Camber & Toe-In * 1.3
- Toe-In Only * .6

FRONT SUSPENSION

	TIME	PRICE		TIME	PRICE
1 SPRING, 4 Leaves 6 Leaves Late 600 & 600D	* 1.3		14 SHOCK ABSORBER	* .5	18.00
2 Leaf, Spring Main O/H	* 1.3	21.00	15 Bumper, Rubber		.91
3 Bushing, Spring End	* 2.4	5.80	16 KNUCKLE	1.5	21.75
4 Pin, Lower		.37			
5 KING PIN HOUSING, Knuckle Supt. O/H To Spares No. 1717593	* 2.8	10.86	17 King Pin		.87
From Spares No. 1717594-	* 2.8	10.86	18 Key		.15
6 Bushing		3.33	19 Thrust Ring		.31
7 Bolt, Upper		.36	20 Ring, Rubber		.13
8 ARM, Upper	* 1.2	7.24	21 BEARING, Inner Roller		5.23
9 Shaft, Upper Arm Inner	.4	2.18	22 Seal		.29
10 Bushing		2.51	23 BEARING, Outer Roller		4.44
11 PLATE		1.09	24 Washer		.10
12 Pad, Support		.55	25 Nut		.30
13 Support		1.81			

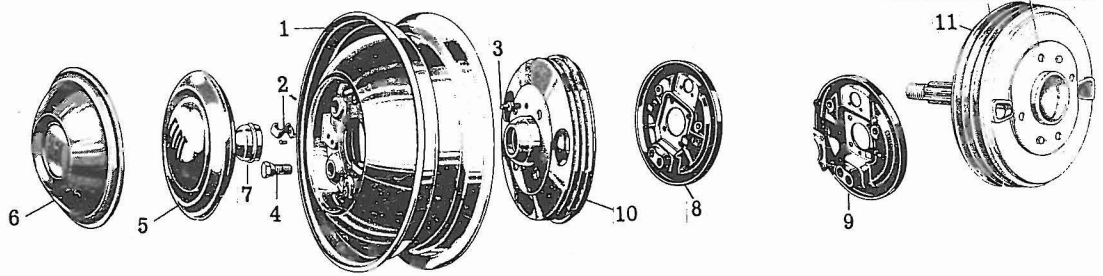

Refinish Wheel .5
 BLEED Brakes:
 Complete *.8
 Fr. or Rr. *.6

WHEELS & BRAKES

1 WHEEL	* .3	10.86	8 PLATE, Fr. Backing	600	.9	6.52
2 Spring w/Rivet		.10	600D		.9	3.26
3 Dowel		.28	9 Rr. Backing	600	1.0	6.88
4 Stud		.27	600D		1.0	3.26
HUB CAP,			10 HUB & DRUM, Front		.6	25.34
5 w/Convex Center		3.01	11 Rear w/Axle		.6	19.91
6 w/Concave Center		3.01	Drum Only		.7	10.14
600D from Spares No. 1899848		2.00	HOSE, Brake (Does Not Incl. Bleed Brakes)		.5	2.90
7 Grease Cap, Front Hub		.29				

* ARE FACTORY SUGGESTED ALLOWANCES
OTHER GLENN MITCHELL ESTIMATED.

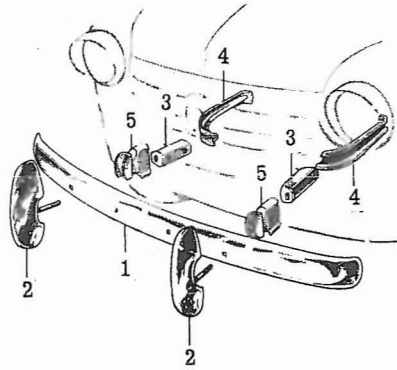

FRONT

R&R Bumper Assy. * .2

	TIME	PRICE
1 FACE BAR	* .6	14.48
2 GUARD	.2	5.43
3 BRACKET, Mtg. (Welded to Body) #	.8	.51
4 Strut, Reinforcement (Welded to Body) #		1.09
# Time after Necessary Disassembly.		
5 Spacer, Mounting		.77

BUMPERS

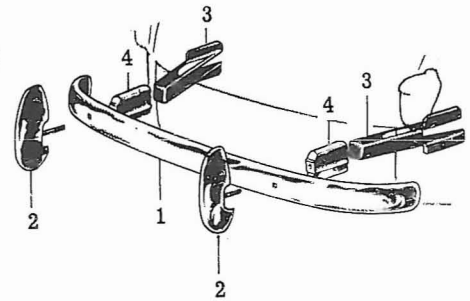

REAR

R&R Bumper Assy. * .2
Bracket time w/Bumper removed.

	TIME	PRICE
1 FACE BAR	.4	16.29
2 GUARD	.2	6.52
3 BRACKET, Mtg.	.3	1.09
4 Spacer, Mtg.		.77

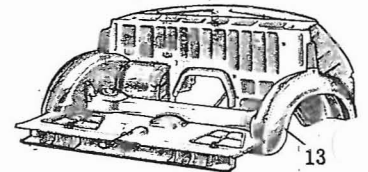
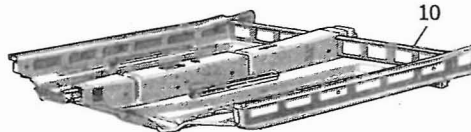
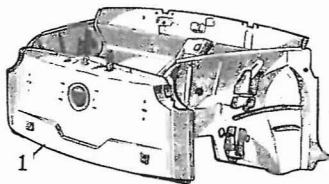

CENTRAL SECTION

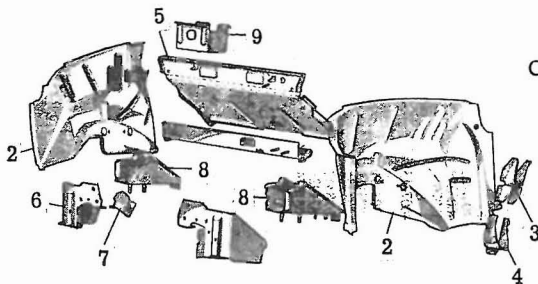

FRONT SECTION

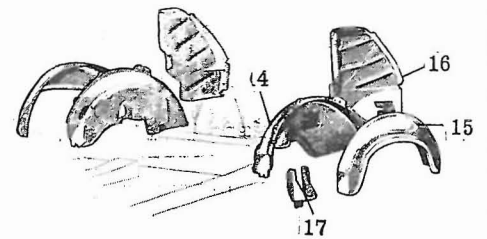

REAR SECTION

FRAME

1 FRAME, Fr. Section Complete	Note 1	40.0	127.00
2 APRON, Fr. Fen., Inner (w/ Fen. Rem.)		4.0	16.29
3 Support, Fr. Shock			1.10
4 Bracket, Fr. Frame Bumper			.73
5 DASHBOARD, Lower Portion			12.67
6 Plate, Front			2.18
7 Reinforcement, Fr. Susp.			.44
8 Strut, Fr. Susp.			3.29
9 Support, Battery		1.8	1.45

NOTE 1: Time Includes All R&R, NOT Align
Wheels or O/H Fr. Susp. Knees.
ADD to O/H Knee

2.5

10 FLOOR, Center			97.74
11 Bracket, Jack		1.0	.91
12 Reinforcement, Floor Side		7.5	3.62
13 FLOOR, Rr. w/W/House Assys. 600			145.00
600D			155.66
14 WHEELHOUSE, Rr. Inner (w/O.S. Rem.)		2.5	9.42
15 Outer (w/Qtr. Rem.)		2.5	7.97
16 PANEL, Rr. Qtr. Inner (w/Qtr. Panel Rem.)		1.5	5.43
17 Bracket, Rr. Spring Bumper			.51